

7.1” Stretched Bar LCD Display

Stretched Bar LCD Display is the special application for smart retail solution. Considering the retail shelf environment, we will provide both Stretched Bar LCD kits and Stretched Bar LCD display with the android Wi-Fi player, which are specially designed for the shelf restricted space digital signage applications.

Stretched Bar display is that the small bar display typically from 11 to 86 inch which are used for advertising, product information and merchandise presentation. The display has the built-in media player are economical choices for catching attention at point of sale, and it can turn your shop into a contemporary retail business to reinforce customers shopping experience. it's been successfully and commonly utilized in supermarket, retail shops and grocery stores, brand chain stores including pharmacy for immersive advertising and makes creating. We also offer high brightness stretched displays up to 2000 nits for outdoor use.



- Ultra-Wide aspect ratio
- Slim Bezel Bar LCD Design
- High Brightness
- Wide Viewing Angle
- LED Backlight and long-life time
- Low Power Consumption
- Anti-Shock & good quality
- Smart advertising player

1. General Features

| Model | Type | SR8.4-600 | SR8.4-600MA | SR8.4-600MB |
|---------|------------------|-------------------|-----------------------------------|-----------------------------------|
| Display | Housing | / | Metal housing | Metal housing |
| | Size | 7.1” | 7.1” | 7.1” |
| | Resolution | 600 x 600 | 600 x 600 | 600 x 600 |
| | Active Area | 127 x 127 mm | 127 x 127 mm | 127 x 127 mm |
| | Brightness | 300 nits | 300 nits | 300 nits |
| | Contrast | 1200:1 | 1200:1 | 1200:1 |
| | Viewing Angle | 160/160 | 160/160 | 160/160 |
| | Color | 16.7M | 16.7M | 16.7M |
| Inputs | Operating System | / | / | Android |
| | Interface | HDMI x 1, VGA x 1 | HDMI x 1, VGA x 1 | RJ45 x 1, USB x 1, Wi-Fi x 1 |
| | CPU | / | / | ARM RK3368 |
| | Memory | / | / | DDR-3, 1GB |
| | Storage | / | / | 8G EMMC |
| Others | Power | 12V, 3W | 12V, 3W | 12V, 3W |
| | Net Weight | 0.5 kg | 0.5 kg | 0.5 kg |
| | Net Size | 152x150x15mm | 152x150x15mm | 152x150x15mm |
| | Appearance | / | Black/white | Black/white |
| | Installation | VESA holes | VESA hole (Stretched Bar rack) | VESA hole (Stretched Bar rack) |

2. Mechanical Characteristics

Unit:mm

Side view

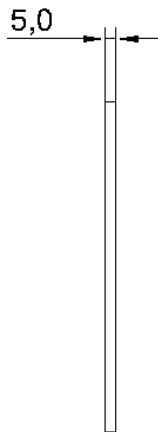

Front view

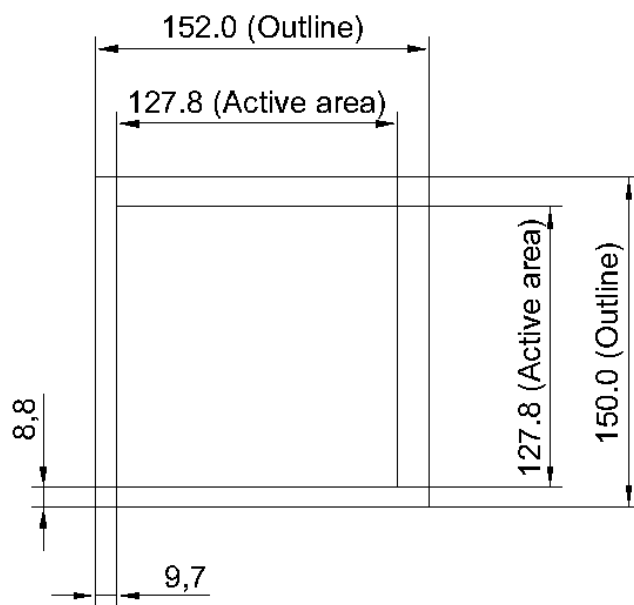

Back view

