

23.6” Shelf Edge LCD Display

Shelf Edge LCD Display is the special application on shelf edge for smart retail solution. Considering the retail shelf environment, we will provide both shelf edge LCD kits and shelf edge LCD display with the android Wi-Fi player, which are specially designed for the shelf restricted space digital signage applications.



Shelf edge display is that the small bar display typically from 11 to 65 inch which are used for advertising, product information and merchandise presentation at shelf edge.

The display has the built-in media player are economical choices for catching attention at point of sale, and it can turn your shop into a contemporary retail business to reinforce customers shopping experience. it's been successfully and commonly utilized in supermarket, retail shops and grocery stores, brand chain stores including pharmacy for immersive advertising and makes creating.

- Ultra-Wide aspect ratio
- Slim Bezel Bar LCD Design
- High Brightness
- Wide Viewing Angle
- LED Backlight and long-life time
- Low Power Consumption
- Anti-Shock & good quality
- Smart advertising player

1. General Features

Model	Type	SR27-160	SR27-160MA	SR27-160MB
Display	Housing	/	Metal housing	Metal housing
	Size	23.6”	23.6”	23.6”
	Resolution	1920x160	1920x160	1920x160
	Active Area	598x50 mm	598x50 mm	598x50 mm
	Brightness	300 nits	300 nits	300 nits
	Contrast	1200:1	1200:1	1200:1
	Viewing Angle	170/170	170/170	170/170
	Color	16.7M	16.7M	16.7M
Inputs	Operating System	/	/	Android
	Interface	HDMI x 1, VGA x 1	HDMI x 1, VGA x 1	RJ45 x 1, USB x 1, Wi-Fi x 1
	CPU	/	/	ARM RK3368
	Memory	/	/	DDR-3, 1GB
	Storage	/	/	8G EMMC
Others	Power	12V, 18W	12V, 18W	12V, 18W
	Net Weight	2.7 kg	2.7 kg	2.7 kg
	Net Size	625x77x15 mm	625x77x30 mm	625x77x30 mm
	Appearance	/	Black/white	Black/white
	Installation	VESA holes	VESA hole (Shelf edge rack optional)	VESA hole (Shelf edge rack optional)

2. Mechanical Characteristics

Unit:mm

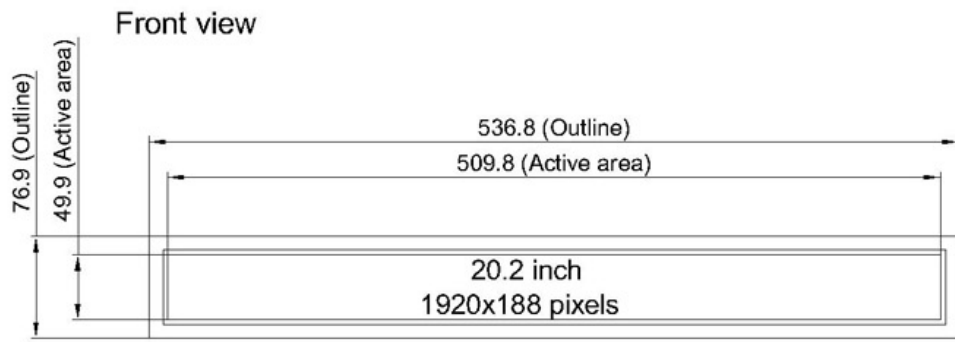

Side view

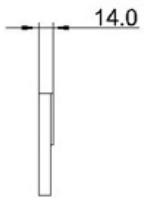

Back view

