

7" TFT LCD DISPLAY

Model: NL700002P0
 Size: 7 inches
 Resolution: 1024*600
 Angle of view: 60 'clock
 Operating temperature: -20~70 degrees C
 Storage temperature: -30~80 degrees C
 Backlight brightness: 260 CD/M2
 Visual angle: 60
 PIN number: 40PIN
 Interface: LVDS 40 bit
 Matching touch: capacitive touch screen



Model :	NL700002P0
Keywords Desc. :	7 inch, 1024*600, TFT LCD, 260nits,40 pins, lvds
Product Class :	Graphic LCD Display
Product Tags :	<ul style="list-style-type: none"> Color TFT-LCD Capacitive Touch LCD
Application :	<ul style="list-style-type: none"> Automotive Display Digital Photo Frame Handheld & PDA Healthcare Industrial Application MID UMPC Portable DVD Player
Panel Type :	a-Si TFT-LCD
Panel Composition :	LCM
Panel Size :	7"
Resolution :	1024×600
Aspect Ratio :	16:9 (W:H)
Form Factor :	Flat Rectangle Display
Orientation :	Landscape type
Active Area :	154.21 (W) × 85.92 (H) mm (A.A)
Outline Dimension :	163.9 (W) × 97 (H) mm
Max. Depth :	2.6 mm

LC Family :	TN
Polarizer :	Transmissive
Brightness :	260 (Typ.)
Contrast Ratio :	800:1 (Typ.)
Viewing Angle :	80/80/60/70 (L/R/U/D)
Viewing Direction :	6 o'clock
Colors Amount :	16.7M
Backlight Type :	WLED
Interface Type :	LVDS
Interface Pins :	40 Pins
Touch Panel :	Optional
Operating Temp. :	-20 ~ 70 °C
Storage Temp. :	-30 ~ 80 °C

2. Mechanical Characteristics

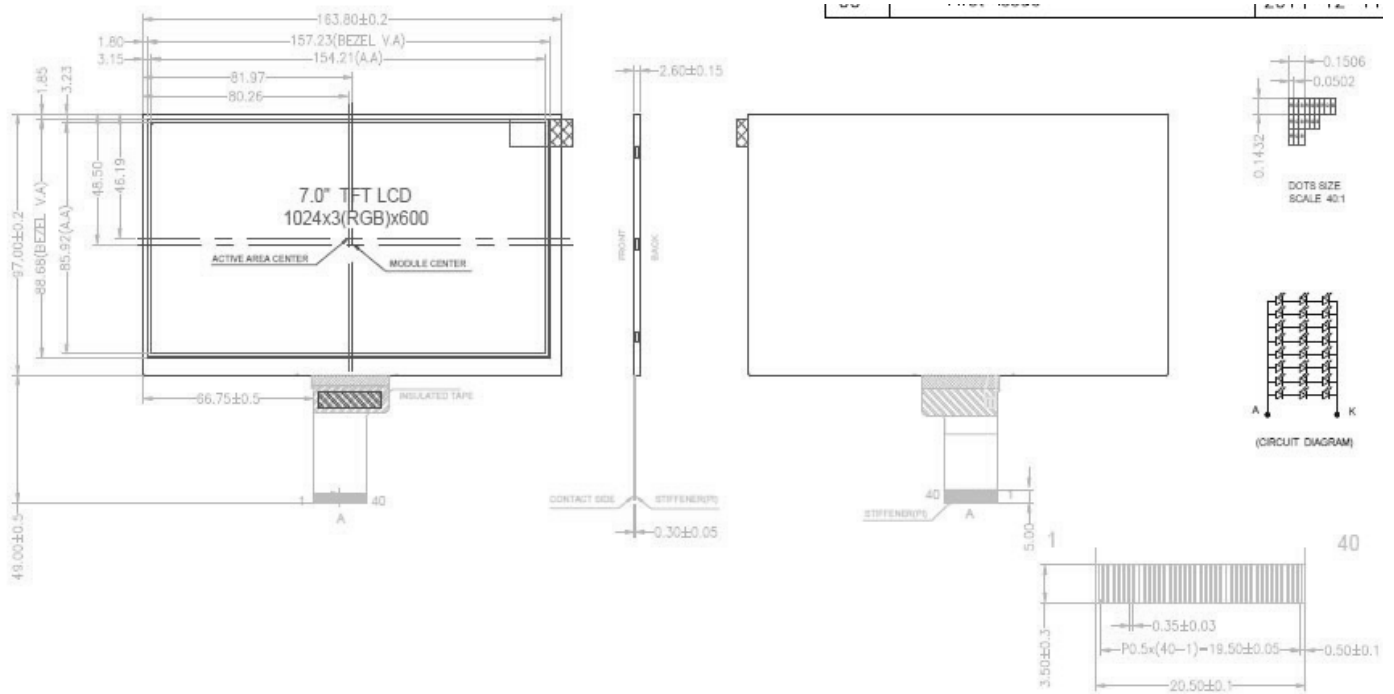

Note: If you need the complete datasheet, please contact us.