

4.5" TFT LCD DISPLAY

Model: NL450007C0

Size: 4.5

Configuration: CTC + ILI9806

Resolution: 480 * 854

Angle of view: 70 °

Operating temperature: -20 ~ 70 ° C

Storage temperature: -30 ~ 80 ° C

Backlight brightness: 400 cd / m2

PIN number: 40 PIN

Interface: RGB 24-bit



Name :	4.5" tft lcd
Model :	NL450007C0
Keywords Desc. :	4.5 inch 480*854 TFT LCD display, 40 pins RGB
Product Class :	Graphic LCD Display
Product Tags :	Color TFT-LCD
Panel Type :	a-Si TFT-LCD
Panel Composition :	LCM
Panel Size :	4.5"
Resolution :	480×854
Aspect Ratio :	9:16 (W:H)
Form Factor :	Flat Rectangle Display
Orientation :	Portrait type
Active Area :	55.44 (W) × 98.64 (H) mm (A.A)
Outline Dimension :	59.87 (W) × 109 (H) mm
Max. Depth :	2.25 mm
LC Family :	TN
Polarizer :	Transmissive
Brightness :	400 (Typ.)
Contrast Ratio :	800:1 (Typ.)
Viewing Angle :	70/70/65/60 (L/R/U/D)

Viewing Direction :	12 o'clock
Colors Amount :	16.7M
Backlight Type :	WLED
Interface Type :	TTL
Interface Pins :	40 Pins
Touch Panel :	Optional
Operating Temp. :	-20 ~ 70 °C
Storage Temp. :	-30 ~ 80 °C

2. Mechanical Characteristics

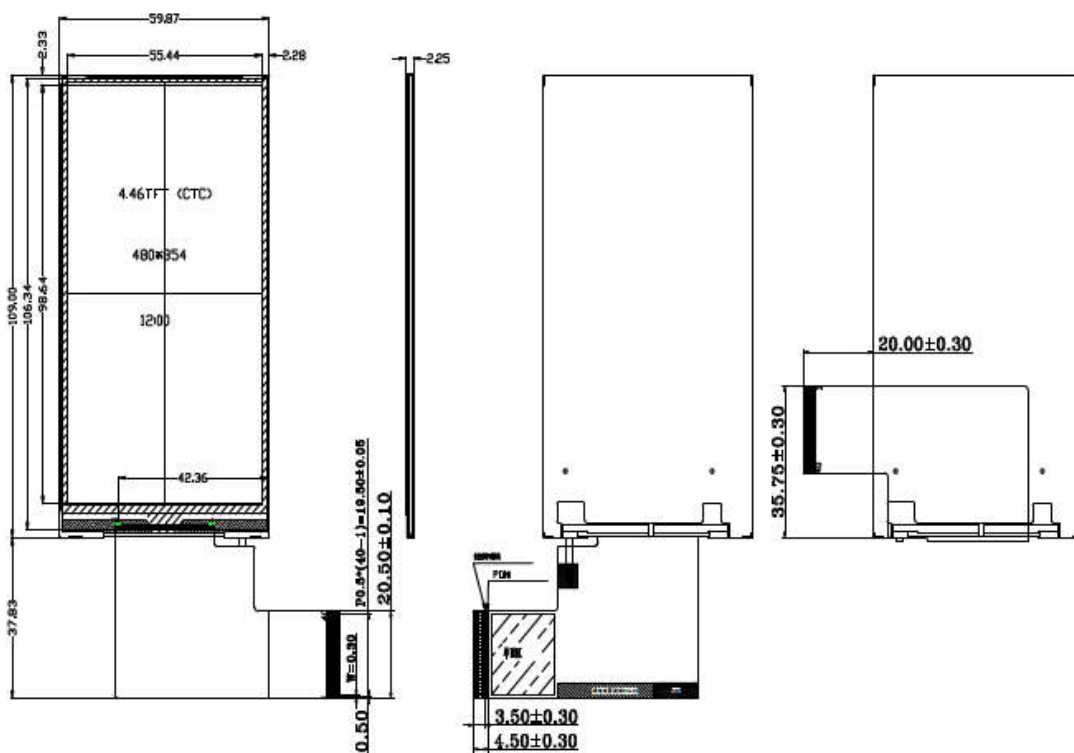

TES:
DISPLAY TYPE: .

1	LED_A1
2	LED_A2
3	LCD_K1
4	LCD_K2
5	GND
6	VDD
7	VS
8	HS
9	PCLK
10	DE
11	R0
12	B1
13	B2
14	B3
15	B4
16	B5
17	B6
18	B7
19	G0
20	G1
21	G2
22	G3
23	G4
24	G5
25	G6
26	G7
27	R0
28	R1
29	R2
30	R3
31	R4
32	R5
33	R6
34	R7
35	RESET
36	CS
37	SCL
38	NC
39	SDI
40	GND

Note: If you need the complete datasheet, please contact us.