

2.0" TFT LCD MODULE

NL200001C0, Size: 2.0 inch TFT LCD Module, Configuration: CTC + ILI9225G, Resolution: 176 * 220, Perspective: 45 °, Operating temperature: -20 ~ 70 ° C, Storage temperature: -30 ~ 80 ° C, Backlight brightness: 250 CD / M2, PIN number: 22PIN, Interface: SPI

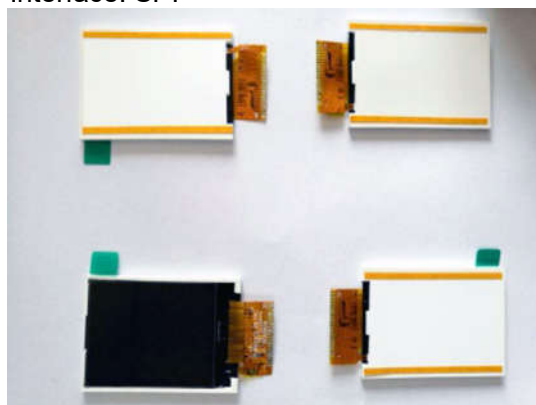

Series :	2 inch 176*220
Model :	NL200001C0
Keywords Desc. :	2 inch 176*220 TFT LCD display, 18 pins SPI 280 cd/m ²
Product Class :	Graphic LCD Display
Product Tags :	Color TFT-LCD Wide Temperature LCD
Panel Type :	a-Si TFT-LCD
Panel Composition :	LCM
Panel Size :	2.0"
Resolution :	176*220
Aspect Ratio :	9:16 (W:H)
Form Factor :	Flat Rectangle Display
Orientation :	Portrait type
Active Area :	31.68 (W) × 39.6 (H) mm (A.A)
Outline Dimension :	41.5 (W) × 49.1 (H) mm
Max. Depth :	2.3 mm
LC Family :	TN
Polarizer :	Transmissive
Brightness :	280 (Typ.)

Contrast Ratio :	500:1 (Typ.)
Viewing Angle :	45/45/45/20 (L/R/U/D)
Viewing Direction :	12 o'clock
Colors Amount :	262K
Backlight Type :	WLED
Interface Type :	SPI
Interface Pins :	36 Pins
Touch Panel :	Without
Operating Temp. :	-20 ~ 70 °C
Storage Temp. :	-30 ~ 80 °C

2. Mechanical Characteristics

#0 THE FIRST ISSUE 2016.06.30

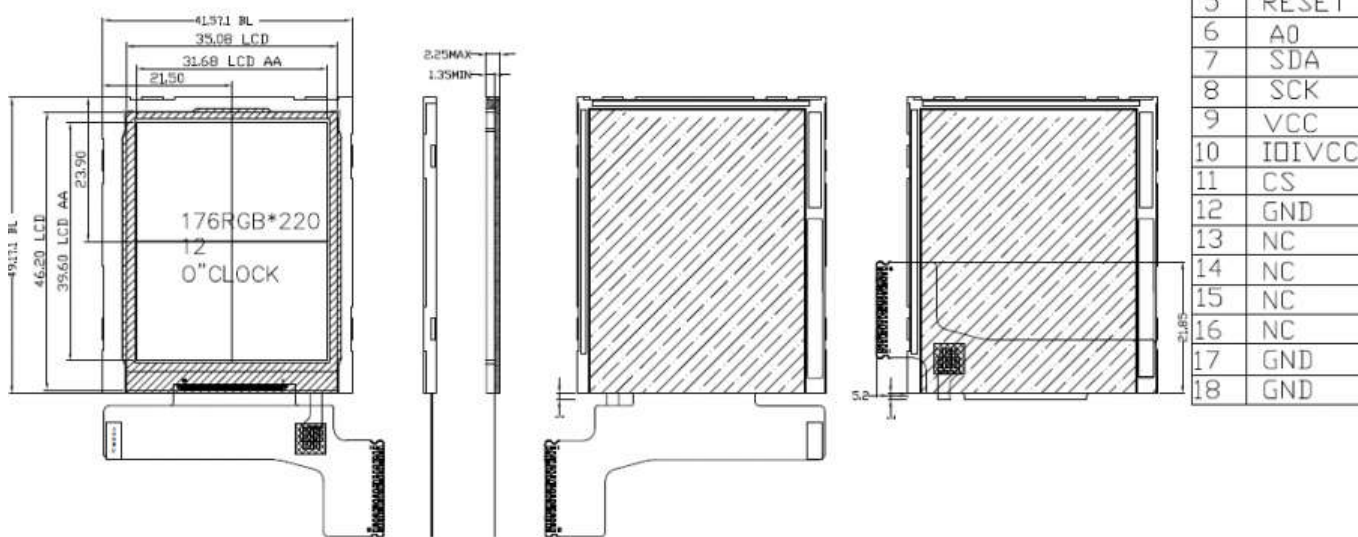

Note: If you need the complete datasheet, please contact us.