

# 1.54" TFT LCD MODULE

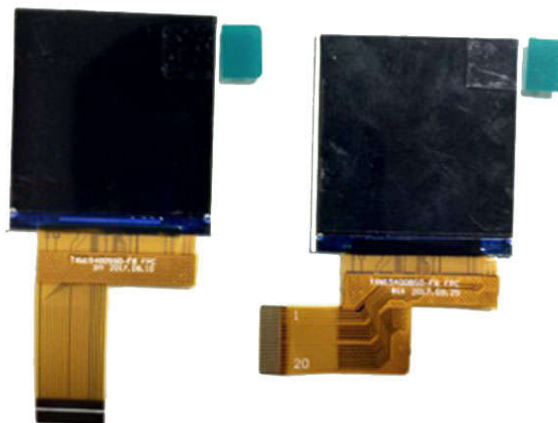

|                     |  |
|---------------------|--|
| Brand :             | SUNUL  |
| Series :            | 1.54 inch  |
| Model :             | NL154005S0   |
| Keywords Desc. :    | 1.54 inch 240*240 TFT LCD display, 20 pins MCU 8 bit |
| Product Class :     | Graphic LCD Display                                  |
| Product Tags :      | Color TFT-LCD<br>IPS LCD                             |
| Panel Type :        | a-Si TFT-LCD   |
| Panel Composition : | LCM  |
| Panel Size :        | 1.54"  |
| Resolution :        | 240×240  |
| Aspect Ratio :      | 1:1 (W:H)  |
| Form Factor :       | Flat Rectangle Display                               |
| Orientation :       | Portrait type  |
| Active Area :       | 27.72 (W) × 27.72 (H) mm (A.A)                       |
| Outline Dimension : | 31.52 (W) × 33.72 (H) mm                             |
| Max. Depth :        | 2.03 mm  |
| LC Family :         | IPS Family   |
| Polarizer :         | Transmissive   |
| Brightness :        | 450 (Typ.)   |

|                     |                       |
|---------------------|-----------------------|
| Contrast Ratio :    | 500:1 (Typ.)          |
| Viewing Angle :     | 80/80/80/80 (L/R/U/D) |
| Viewing Direction : | Symmetry              |
| Colors Amount :     | 262K                  |
| Backlight Type :    | WLED                  |
| Interface Type :    | CPU                   |
| Interface Pins :    | 20 Pins               |
| Touch Panel :       | Without               |
| Operating Temp. :   | -20 ~ 70 °C           |
| Storage Temp. :     | -30 ~ 80 °C           |

## 2. Mechanical Characteristics

| PIN | NAME        |
|-----|-------------|
| 1   | LED+        |
| 2   | LED-        |
| 3   | VDD(2.8V)   |
| 4   | IOVDD(1.8V) |
| 5   | GND         |
| 6   | RESET       |
| 7   | /CS         |
| 8   | RS          |
| 9   | /WR         |
| 10  | /RD         |
| 11  | GND         |
| 12  | DB0         |
| 13  | DB1         |
| 14  | DB2         |
| 15  | DB3         |
| 16  | DB4         |
| 17  | DB5         |
| 18  | DB6         |
| 19  | DB7         |
| 20  | GND         |

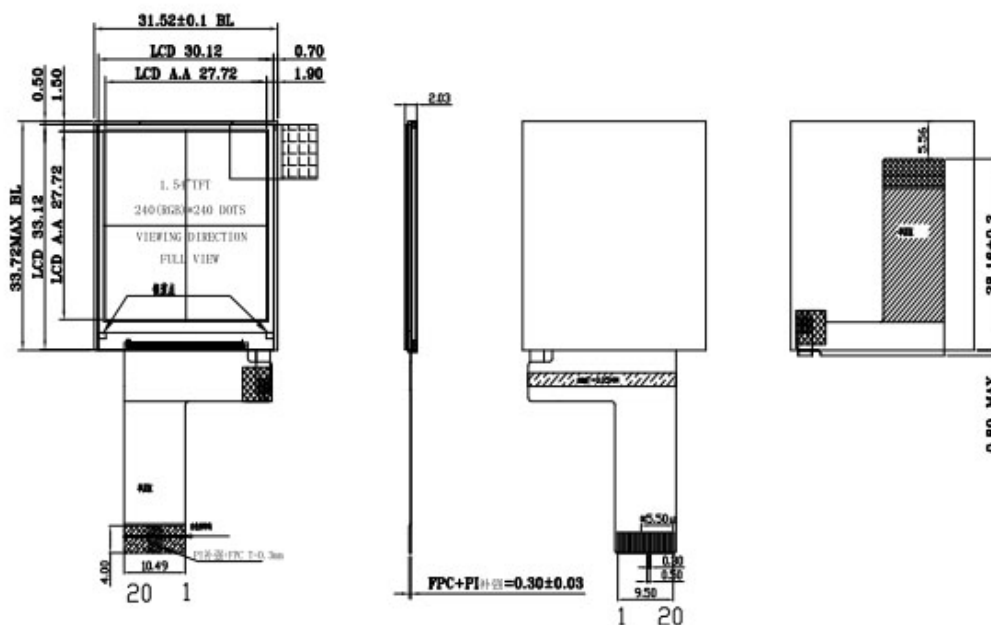

NOTES:  
 1. DISPLAY TYPE:  
 Main LCD: 1.54" TFT, Transmissive  
 2. OPERATING TEMP: -20° C ~ 70° C  
 3. STORAGE TEMP : -30° C ~ 80° C  
 4. MAIN LCD DRIVER: ST7789V  
 5. BACKLIGHT: 3CHIP-WHITE LED  
 6. Unspecified Tolerances: ±0.2mm

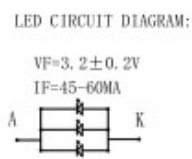

Note: If you need the complete datasheet, please contact us.